

Advancing negative pressure, targeting positive outcomes

Avance® Solo is a battery powered single use negative pressure wound therapy system. It aims to promote faster healing, improve patient mobility and reduce surgical site events such as surgical site infections (SSI).

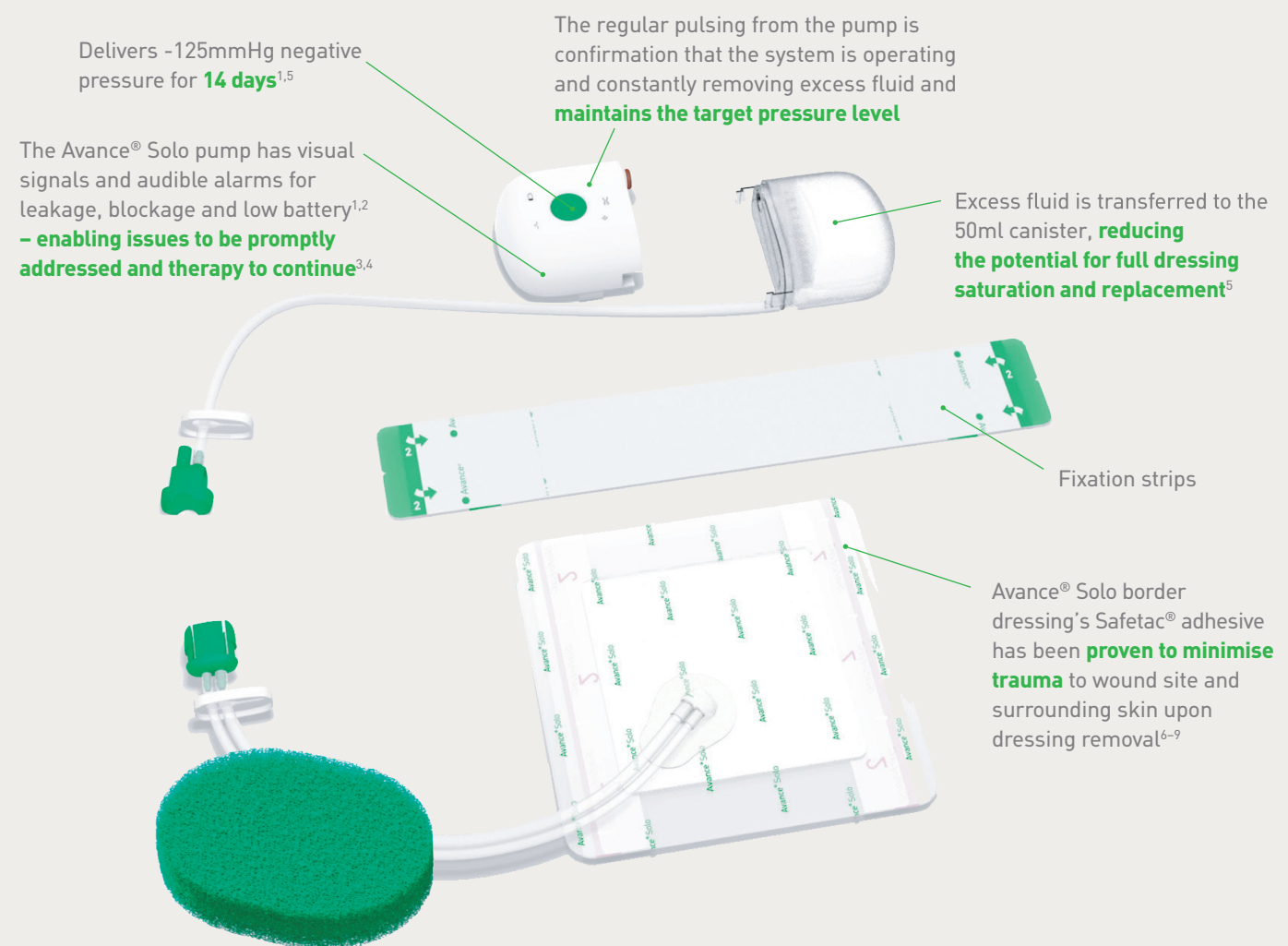

Avance® Solo

Mölnlycke®

How Avance® Solo works

Avance® Solo is a battery powered single use negative pressure wound therapy system which transports exudate from the wound to the dressing and canister. It delivers a continuous negative pressure of -125mmHg⁵ and is suitable for use in closed incisions and chronic wound indications.

What are the benefits of Avance Solo?

- Delivers -125mmHg negative pressure for 14 days, potentially right through your patient's recovery^{1,5}
- Controlled Fluid Management (CFM) technology maintains negative pressure by transporting excess fluid to the 50ml canister^{5,10,11}
- The bordered dressing conforms to body contours in difficult to dress areas¹², and its Safetac® adhesive has been proven to minimise trauma to the wound site and surrounding skin upon dressing removal⁶⁻⁹
- The Avance Solo Pump has visual signals and audible alarms for leakage, blockage and low battery^{1,2}, enabling issues to be promptly addressed and therapy to continue^{3,4}

Areas of use

Closed Incision Negative Pressure Therapy (ciNPT)

Avance Solo NPWT is used to remove exudate from closed incision wounds after orthopaedic (primary and revision arthroplasties), cardiothoracic (CABG and sternotomy), obstetric/gynaecological (c-section and abdominal hysterectomy), general/colorectal (laparotomy and ventral hernia repair), vascular (groin incisions), and plastic surgeries (abdominal wall reconstruction and mastectomy).



Disposable Negative Pressure Wound Therapy (dNPWT) for open wounds

Avance Solo NPWT is indicated for removal of low to moderate amounts of exudate from chronic, acute, traumatic, subacute and dehisced wounds, as well as from grafts and flaps.



For contraindications, warnings and precautions please see the instructions for use.

Avance Solo assortment

Art. no	ciNPT
8881020	Avance Solo closed incision starter kit (10cm x 20cm)
8881030	Avance Solo closed incision starter kit (10cm x 30cm)
8881035	Avance Solo closed incision starter kit (10cm x 35cm)
881020	10cm x 20cm dressing
881030	10cm x 30cm dressing
881035	10cm x 35cm dressing
Art. no	dNPWT
8880050	Pump and canister kit
880050	Replacement canister
881515	15cm x 15cm dressing
881520	15cm x 20cm dressing
881530	15cm x 30cm dressing
882020	20cm x 20cm dressing
882525	25cm x 25cm dressing
882000	Foam wound filler

References: 1. Avance Solo CMM Data on file (ref 16). 2. Avance Solo CMM Data on file (ref 17). 3. Avance Solo CMM Data on file (ref 14). 4. Avance Solo CMM Data on file (ref 15). 5. Avance Solo CMM Data on file (ref 10). 6. Van Overschelde, P. et al. A randomised controlled trial comparing two wound dressings used after elective hip and knee arthroplasty. Poster presentation at 5th Congress of the WUWHS, Florence, Italy, 2016. 7. Silverstein P. et al. An open, parallel, randomized, comparative, multicenter study to evaluate the cost-effectiveness, performance, tolerance, and safety of a silver-containing soft silicone foam. Journal of Burn Care and Research, 2011. 8. Gee Kee E.L. et al. Randomized controlled trial of three burns dressings for partial thickness burns in children. Burns, 2014. 9. Solanilla A.C. et al. Prospective, randomized, non-inferiority investigation to compare effects of Mepitel® One and UrgoTul®. 10. Avance Solo CMM Data on file (ref 11). 11. Avance Solo CMM Data on file (ref 13). 12. Avance Solo CMM Data on file (ref 18).

Find out more at www.molnlycke.co.uk

Mölnlycke, Unity House, Medlock Street, Oldham, OL1 3HS. Tel +44 (0) 800 731 1876.
The Mölnlycke, Avance and Safetac trademarks, names and logos are registered globally to one or more of the Mölnlycke Health Care group of companies. © 2020 Mölnlycke Health Care AB. All rights reserved. UKWC0955

Mölnlycke®